

Aquaglide TakeOff Owners Manual

Product Instructions and Warnings

Watersports can be safe and fun for all levels of enthusiasts. The Operator's Manual is presented to enhance your enjoyment of the sport. It is intended to alert you to some of the potentially dangerous conditions that can arise in all watersports.

To reduce the risk of injury or death, follow these guidelines:

- Only use your tube with a responsible watercraft operator who knows how to operate a watercraft properly.
- Take all reasonable precautions in the use and operation of your tube & boat.
- Teach anyone using your tube how to attach it to the rope, how to ride it, and how to maintain it.
- * The stress on the rope is different from the stress on the tube, and will vary with the weight of the passengers, design, and surface area of the tube.
- Never strap or attach anyone to the tube or cover. Never put your feet or hands through the strapping of the towing system or handles. Never wedge your hands or feet under the cover or between the cover and the tube.
- Never attempt jumps or dangerous tricks with your tube. If more than one tube is being towed, avoid collisions with other tubes.
- Scout the area before use to avoid any debris or obstacles that might present a safety hazard.
- Know your own limits. Stop when you are tired. Act responsibly. Be in good physical condition and be cautious in your use of this or any other towable tube.
- Check the rope and connector for frays, cuts, sharp edges, knots, or wear before each use. Discard rope if any such condition exists or if rope appears to be worn. Such conditions may lead to breaks.
- Do not use tow rope with elastic or bungee material to pull skiers or riders. Such an addition can break or stretch which may lead to injury of users or boat occupants.
- Rope is subject to deterioration when exposed to direct sunlight. The life of the product will be extended when stored away from sunlight.
- The tow rope should be replaced when signs of deterioration appear, indicated by the existence of discoloration, wearing, fraying or raveling.
- Do not add hardware or attachments that are not supplied by the manufacturer.

Wakeboard Towers and Tow Points

Wakeboard towers are not designed for pulling towables. Use only lifting eyes for towing tubes with 2 or more riders. Do not tow inflatables from ski pylons or ski eyes unless recommended by the boat manufacturer. Tow pylons and ski eyes installed aftermarket are not intended for towing inflatables. Aquaglide assumes no liability for injuries or damages resulting from not following these instructions.

Proper inflation

Proper inflation is the key to optimum performance and durability of this product. **During use**, the cover should be taught with few wrinkles, and you should barely sink into the tube when standing on it. If the tube is under inflated, damage can occur to the tube when towing. Use caution and do not over-inflate above 1.4 psi. **When not in use**, be sure to remove some air from the tube and move the tube to a shaded location. Exposure to direct sunlight heats the tube and causes the air inside to expand, causing serious damage to the seams and I-beams.

Rapid Inflate Valve Inflating – Unscrew the cap and insert the pump fitting into the valve. Be sure to open the flap at the base of the valve. Remove the pump fitting after filling completely and make sure the black flap is seated securely closing the valve. If the flap is not seated, pull red tab to close valve. Replace the cap. **Deflating** – Unscrew the cap and use a dull object to hold the flap open while the product deflates. Replace the cap for storage.

Assembly Instructions

1. Lay the product out on a flat surface without sharp objects that could puncture the PVC bladder or cover. If the product has an outer cover, make sure the inside PVC bladder is unfolded and the valves are in the correct position, aligned with the cover valve openings.
2. Inflate the product to about 50% full. If your product has a cover, re-check to make sure it is correctly aligned with the PVC bladder and valves. If there is more than one chamber in the bladder, inflate the outer chamber first. After the cover is aligned with the PVC bladder inflate the chambers to 100% starting with the outer chamber

DO NOT DRAG the product into the water. Carry the Aquaglide product to avoid wear on the cover and possible punctures of the PVC bladder.

Anchoring Instructions

To anchor the product, always use the quick release towing attachment. For longer term anchoring run the anchor line from the towing attachment through the fitting in the center of the bottom of the tube, to anchor the tube in the middle.

Maintaining and monitoring Proper Inflation

It is important to monitor the amount of air in your Aquaglide product as heat will cause the bladder to expand, possibly damaging seams or I-beams. If you leave a full tube sitting in the sun for any length of time it will expand. Either store it in the shade or let some air out. Don't leave your product on the beach, dock or boat full of air! If the product is stored out of the sun in a cool place, you may need to add some air. Check and adjust the inflation level each time you use your product for maximum performance and enjoyment.

Towing Attachment

Use a tow rope of at least 4100 lbs. tensile strength for pulling four people on an inflatable tube. For five to six riders use a rope with 6100 lbs average tensile strength. The tow rope should be at least 50 feet in length but not exceed 65 feet. Attach your Aquaglide towable to the tow rope using the quick connect attachment.

Storage

When taking the product out of the water, pull it out using the front towing strap so the water is able to drain out of the mesh drains in the bottom back. Allow the Aquaglide to dry completely to prevent mildew. If using in salt water, rinse the product with fresh water and allow to dry completely before storing. Release all of the air from the chamber(s) and fold the Aquaglide. It is best to store the product inside a warm area during cold weather. Do not expose to freezing temperatures, as it can damage the material and cracks can occur in the PVC bladder.

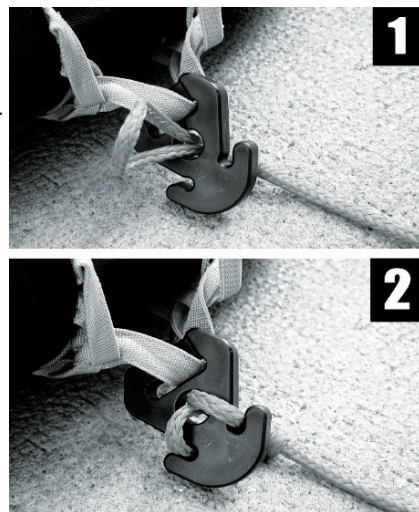

Troubleshooting Guide

Product won't hold air. Remove and re-install valve to make sure it is installed properly. Add some air if you suspect the product was not inflated fully. If necessary to repair a hole in the PVC bladder, use the PVC Repair Guide in this manual.

Valve is leaking: Make sure that the valve is screwed into the threads correctly. Valve and cap must be screwed down tightly.

Bladder does not get firm and/or Cover is loose: Your air pump may not produce enough pressure to completely fill the bladder. Top off your inflatable as necessary with an Aquaglide double action hand or foot pump. The cover should fit snugly over the well inflated product. If the cover remains loose, add more air.

PVC Hull Repair Guide

The Aquaglide bladder is constructed of high quality PVC. Every hull is inflated at the factory and tested for 12 hours before shipping to insure reliability. PVC is not puncture proof, and leaks can occur. Often, leaks in the hull are caused by the valves not being tightly secured. Always test this before assuming a repair is necessary. The Aquaglide comes with a small repair kit that is sufficient to fix most small punctures. You can also purchase PVC patch materials and instructions at your marine dealer, or contact North Sports for more information.

Materials and Tools Needed

- Aquaglide repair kit
- A sponge and Soapy water
- Paper towels
- A small square of 220-grit sandpaper or similar
- Scissors
- Duct tape
- A piece of the vinyl repair material large enough to extend at least 1.2 cm (1 inch) to either side and beyond each end of the hole or tear

Repairing PVC Bladder

- Remove the PVC bladder using the zipper access along the back of the cover.
- Locate the problem area by inflating the PVC bladder and listening for the leak. If you do not hear the leak, wipe down suspect areas liberally - the entire bladder if necessary - with a sponge soaked in soapy water. The location of the leak will become apparent when the air exiting the PVC bladder makes the soapy water bubble.
- Dry the area around the hole, taking care not to lose its location. Mark a 4-cm (about 1.5-inch) diameter circle around the hole with a felt tip pen, and make a dot on the hole itself.
- Deflate the bladder and prepare the surface. Place the bladder flat, with no wrinkles in the patch area. Using 220-grit sandpaper, lightly sand the area 1 inch around the hole or tear. Blow away dust. Clean the area to be repaired with a solvent such as acetone and let dry. Do not touch this area with your fingers; any oil from your finger may cause the patch to fail.
- For small holes, cut the piece of vinyl repair material into a circle about 2.5 cm (1 inch) in diameter) and lightly sand one side of this patch with the sandpaper and clean with solvent.
- For large tears, cut a piece of Duct tape and place inside the hull with the sticky side up, folding the edges of the tear onto the tape so that the boat retains it's original shape and that the edges of the tear are unwrinkled, horizontal and adjacent each other. Using scissors cut the piece of vinyl repair material into a shape that will extend at least 2.5 cm (1 inch) to either side and beyond each end of the tear and lightly sand one side of this patch with the sandpaper, and clean with solvent.
- Use the glue from the supplied repair kit, or other glues designed for PVC to make the repair. Make sure to follow the instructions on the glue. There are several types of glue, so carefully read and follow the instructions on the glue you are using.
- Allow repair to dry in level position according to the glue instructions. Inflate the bladder to 25%-50% and leave overnight to insure that the repair is sound and all holes have been patched.
- Roll up the Bladder lengthwise so that the valves will align with the valve openings and insert the bladder back inside the cover.

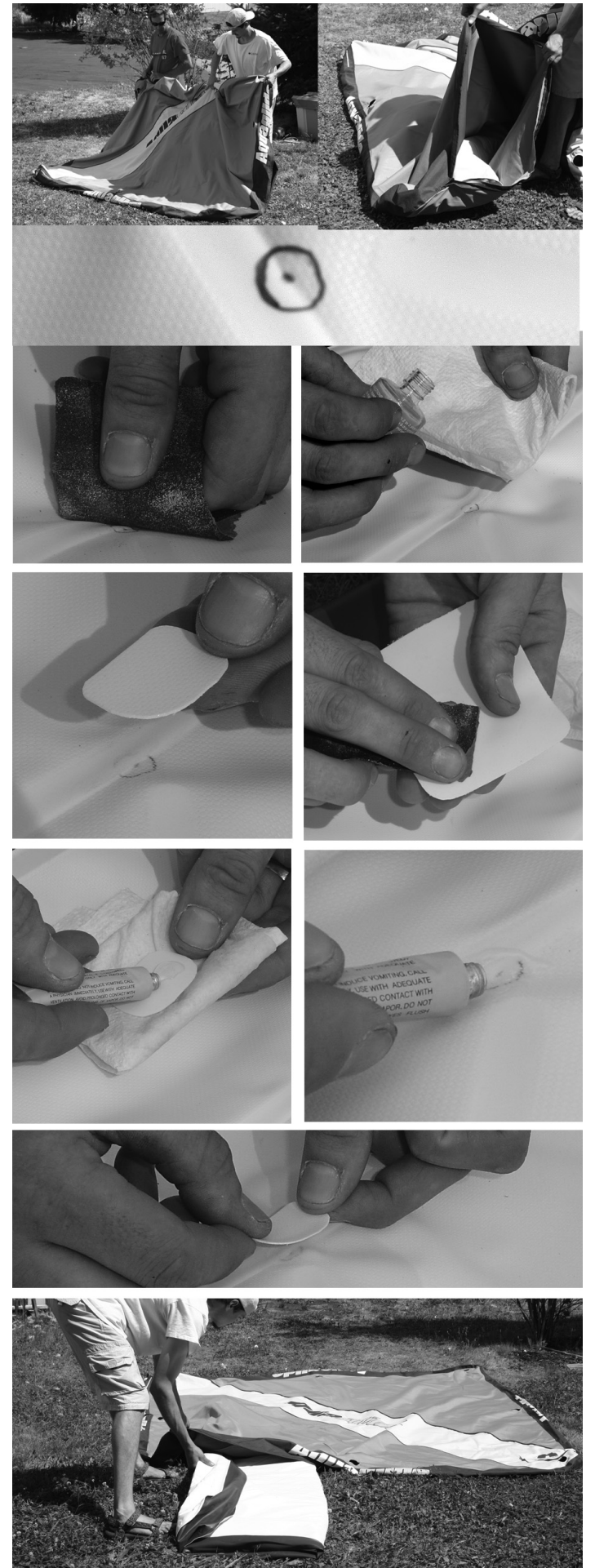

for more information go to our website at
www.Aquaglide.net