

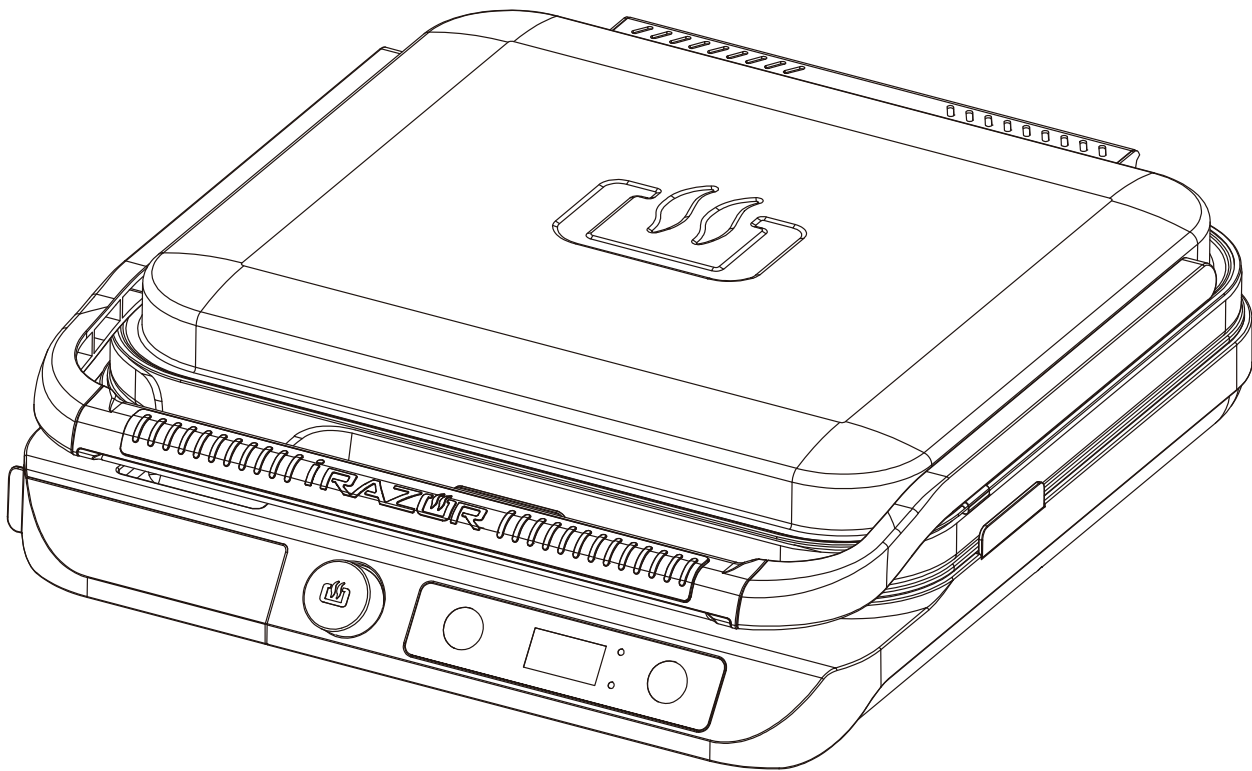

# OWNER'S MANUAL

## IRAZOR INDUCTION COOKING GRIDDLE

Model No. IGT2321R / IGT2321B  
Manufacture Code: IGT2321



### WARNING

**FOR YOUR SAFETY:**

DO NOT LEAVE THIS APPLIANCE UNATTENDED WHILE IN USE.



### WARNING

**FOR YOUR SAFETY:**

DO NOT LEAVE THE LID CLOSED FOR EXTENDED PERIODS WHILE IN USE.



### WARNING

**FOR YOUR SAFETY:**

Do not use appliance for other than intended use.



### WARNING

**FOR YOUR SAFETY:**

Do not attempt to open or repair, contact customer service 1-800-694-0013 with any service related issues.



### WARNING

**FOR YOUR SAFETY:**

When moving appliance, always be aware not to touch hot surfaces, or possible spillage of hot liquids it may contain.



### WARNING

**FOR YOUR SAFETY:**

Use of accessories or equipment not supplied by the manufacturer may cause damage or malfunctioning of your appliance or result in injuries.

### Table of Contents

IMPORTANT SAFEGUARDS .....	Page 2
SPECIFICATION .....	3
PARTS LIST & EXPANDED VIEW .....	4
ASSEMBLY INSTRUCTIONS .....	5
CONTROL PANEL .....	6
OPERATING INSTRUCTION .....	6
PROTECTION ERROR SIGN .....	7
CARE OF THE INDUCTION COOKER .....	7
WARRANTY .....	7

**⚠ WARNING:** This product can expose you to lead and lead components, which are known to the State of California to cause cancer and birth defects or other reproductive harm. For more information go to [www.P65Warnings.ca.gov](http://www.P65Warnings.ca.gov).



### CAUTION

**FOR YOUR SAFETY:**

Do not immerse in water.  
Read instructions before using.



### CAUTION

**FOR YOUR SAFETY:**

60 Minutes “on” in a two hour period.



### CAUTION

**FOR YOUR SAFETY:**

Do not use for deep frying.



### WARNING

**FOR YOUR SAFETY:**

For household and indoor use only!

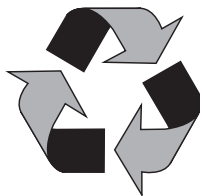

Made from 75% Bagasse  
(environmentally friendly sugar  
cane pulp by-product)



# IMPORTANT SAFEGUARDS

**▲ When using electrical appliances, basic safety precautions should always be followed, including the following:**

- 1. READ ALL INSTRUCTIONS.**
- 2. Do not touch hot surfaces. Use handles and hot pads or knobs.**
- 3. To protect against electric shock, do not immerse cord, plugs, or the Induction Cooker in or under water or other liquid. See instructions for cleaning.**
- 4. Close supervision is necessary when any appliance is used by or near children.**
- 5. Unplug from outlet when not in use and before cleaning. Allow to cool before putting on or taking off parts, and before cleaning the appliance.**
- 6. Do not operate any appliance with a damaged cord or plug or after the appliance malfunctions, or has been damaged in any manner. Return appliance to the nearest authorized service facility for examination, repair or adjustment.**
- 7. The use of accessory attachments not recommended by appliance manufacturer may cause injuries.**
- 8. Do not use outdoors.**
- 9. Do not let cord hang over the edge of table or counter, or touch hot surfaces.**
- 10. Do not place on or near a hot gas or electric burner, or in a heated oven.**
- 11. Extreme caution must be used when moving an appliance containing hot oil or other hot liquids.**
- 12. If the plug gets hot, please call a qualified electrician.**
- 13. Do not use this appliance for other than intended use.**
- 14. Use extreme caution when removing the drip pan or disposing of hot grease.**
- 15. Do not clean Induction Cooker with metal scouring pads. Pieces can break off the pad and touch electrical parts creating a risk of electric shock.**
- 16. To assure safe operation, oversized utensils or food must not be inserted into the Induction Cooker.**
- 17. A fire may occur if this appliance is covered or touching flammable material, including curtains, draperies, walls, etc. when in operation.**
- 18. Condensation and a grease deposit may form around the door and the air and steam outlet grilles. This is normal.**
- 19. CAUTION: Never leave the Induction Cooker unattended when in use.**
- 20. Extreme caution should be exercised when using containers other than Induction Cooker proof metal, glass or ceramic.**
- 21. Do not store any materials other than the manufacturer’s recommended accessories in the Induction Cooker when not in use.**
- 22. Do not place any of the following materials in the Induction Cooker: paper, cardboard, plastic and the like.**
- 23. If the supply cord is damaged, it must be replaced by the manufacturer, its service agent or similarly qualified person in order to avoid a hazard.**
- 24.  Warning: the temperature of accessible surfaces may be high when the appliance is operating.**

- 25. The instructions shall state that appliances are not intended to be operated by means of an external timer or separate remote-control system.**
- 26. This appliance can be used by children aged from 8 years and above and persons with reduced physical, sensory or mental capabilities or lack of experience and knowledge if they have been given supervision or instruction concerning use of the appliance in a safe way and understand the hazards involved. Children shall not play with the appliance. Cleaning and user maintenance shall not be made by children unless they are older than 8 and supervised. Keep the appliance and its cord out of reach of children less than 8 years.**
- 27. Children being supervised not to play with the appliance.**
- 28. This appliance is for household use only.**
- 29. This appliance is not intended for use by person (including children) with reduced physical, sensory or mental capabilities, or lack of experience and knowledge, unless they have been given supervision or instruction concerning use of the appliance by a person responsible for their safety.**
- 30. WARNING: If the surface is cracked, switch off the appliance to avoid the possibility of electric shock.**
- 31. Do not use metallic fasteners to hold the fabric in place. Sharp utensils should not be used.**
- 32. Do Not Cook on Broken Cook-Top - If cook-top should break, cleaning solutions and spills may penetrate the broken cook-top and create a risk of electric shock.**
- 33. Clean Cook-Top with Caution - If a wet sponge or cloth is used to wipe spills on a hot cooking area, be careful to avoid steam burn, some cleaners can produce noxious fumes if applied to a hot surface.**
- 34. Do not place metallic objects such as knives, forks, spoons and lids on the Table Stove since they can get hot.**
- 35. To reduce the risk of fire, do not place any heating or cooking appliance beneath the appliance.**
- 36. To reduce the risk of fire, do not mount unit over or near any portion of a heating or cooking appliance.**
- 37. To reduce the risk of electric shock, do not mount over a sink.**
- 38. To reduce the risk of fire, do not store anything directly on top of the appliance surface when the appliance is in operation.**
- 39. Always attach plug to appliance first, then plug cord in the wall outlet. To disconnect, turn any control to “off”, then remove plug from wall outlet.**
- 40. This appliance is not intended for deep frying foods.**
- 41. CAUTION: Do not use an extension cord.**
- 42. CAUTION: Preheating the appliance prior to the temperature or abnormal tests was waived based.**
- 43. CAUTION: This appliance has a polarized plug (one blade is wider than the other). To reduce the risk of electric shock, this plug is intended to fit into a polarized outlet only one way. If the plug does not fit fully into the outlet, reverse the plug. If it still does not fit, contact a qualified electrician. Do not attempt to modify the plug in any way.**
- 44. CAUTION:**

# IMPORTANT SAFEGUARDS-CONTINUED

- a) A short power-supply cord (or detachable power-supply cord) is provided to reduce the risk resulting from becoming entangled in or tripping over a longer cord.
- b) Longer detachable power-supply cords or extension cords are available and may be used if care is exercised in their use.
- c) If a longer detachable power-supply cord or extension cord is used:
  - 1) The marked electrical rating of the cord set or extension cord should be at least as great as the electrical rating of the appliance;
  - 2) The cord should be arranged so that it will not drape over the countertop or tabletop where it can be pulled on by children or tripped over unintentionally; and
  - 3) If the appliance is of the grounded type, the cord set or extension cord should be a grounding-type 3-wire cord.
- 45. CAUTION: Flashing light (or other visual indicator) indicates ready to operate. Avoid any contact with moving parts.
- 46. Proper Installation – Be sure your appliance is properly installed and grounded by a qualified technician.
- 47. Never Use Your Appliance for Warming or Heating the Room.
- 48. Do Not Leave Children Alone – Children should not be left alone or unattended in area where appliance is in use. They should never be allowed to sit or stand on any part of the appliance.
- 49. Wear Proper Apparel – Loose-fitting or hanging garments should never be worn while using the appliance.
- 50. User Servicing – Do not repair or replace any part of the appliance unless specifically recommended in the manual. All other servicing should be referred to a qualified technician.
- 51. Storage in or on Appliance – Flammable materials should not be stored in an oven or near surface units.
- 52. Do Not Use Water on Grease Fires – Smother fire or flame or use dry chemical or foam-type extinguisher.
- 53. Do Not Soak Removable Heating Elements – Heating elements should never be immersed in water.
- 54. Check and ensure that the supply voltage matches the voltage given on the specification plate under the induction cooker.
- 55. The electrical connections must satisfy local regulations. The valid national and local electrical regulations must be followed.
- 56. Make sure to have good ventilation for the induction cooker.
- 57. The induction unit must not be placed near or on any hot source.
- 58. Make sure that installation, support and inspection are done by qualified personnel.
- 59. Make sure that the cooker is well positioned and free from exposure to any vibration.
- 60. Do not touch any parts inside the cooker.
- 61. If supply cord is damaged, it must be replaced by the manufacturer, its service agent or similarly qualified personnel in order to avoid a hazard.
- 62. Warning: Changes or modifications to this unit not expressly approved by the party responsible for compliance could void the user’s authority to operate the equipment.

# SAVE THESE INSTRUCTIONS



SPECIFICATION

Model No.	IGT2321B, IGT2321R
Output	1600W / 120Vac / 60Hz
Cooking Area	249 Sq Inch
Griddle Material	#430 Stainless Steel
Product Dimensions:	17.44 L x 18.35 W x 5 H (Inch)

PARTS LIST

1	Lid Handle*	I2321-010
2	Lid*	I2321-020
3	Griddle Surface	I2321-030
4	Hinge Pin*	I2321-040
5	Induction Cooker	I2321-050
6	Grease Cup*	I2321-060
7	Control Knob*	I2321-070

\* Pre-assembled

EXPANDED VIEW

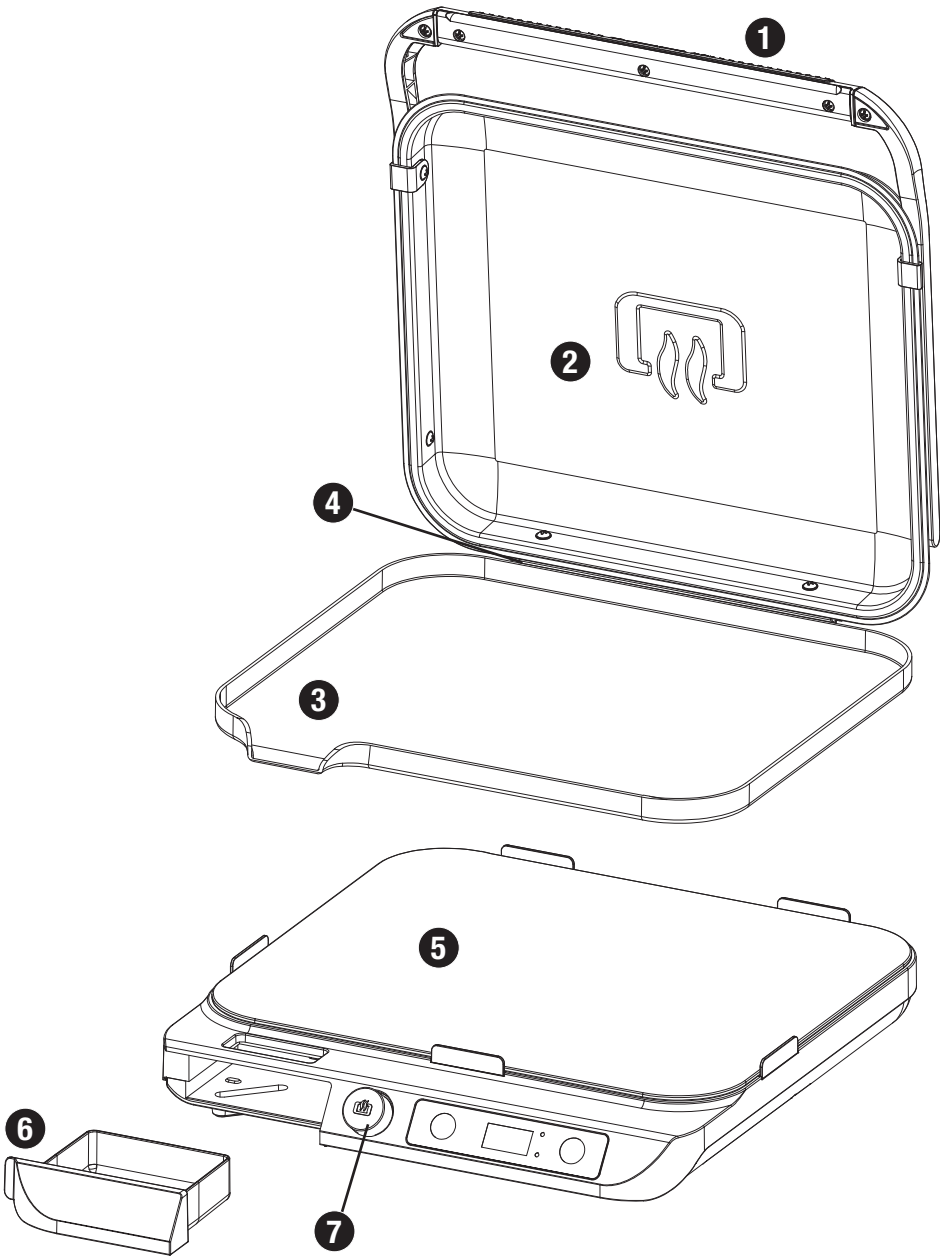



ASSEMBLY INSTRUCTIONS

DO NOT RETURN TO PLACE OF PURCHASE.

For assistance, call 1.800.694.0013 toll-free. Please have your owner’s manual and model number available for reference.

Assembly Tips:

- 1. Select an area where you will assemble this product. To protect components, choose a smooth surface that’s free of cracks or openings.
- 2. Spread out all parts.
- 3. For best results, complete each step in the order presented.

1

Place griddle with lid onto induction cooker

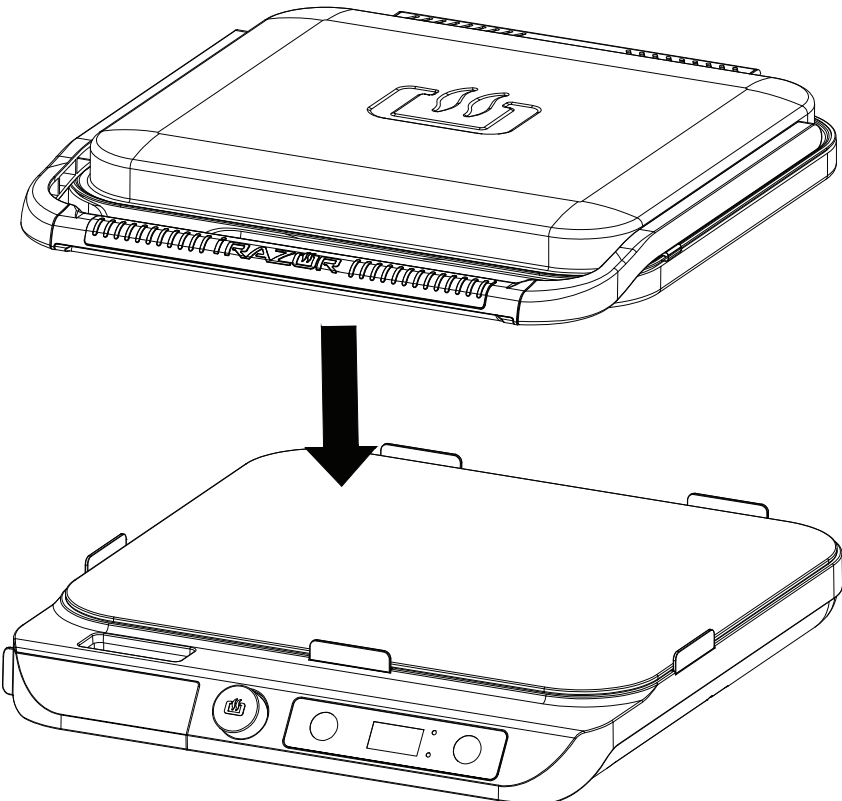

The diagram illustrates the first step of assembly. At the top, a griddle with its lid closed is shown. A large black arrow points down from the griddle to the induction cooker base below. The base has a control panel with a power button, a digital display, and two indicator lights. The griddle is positioned directly above the base, ready to be placed on top.

2

Always using the handle to open and close

Note: Never lift the unit by the lid and never carry it using the handle. Use two hands to carry it.

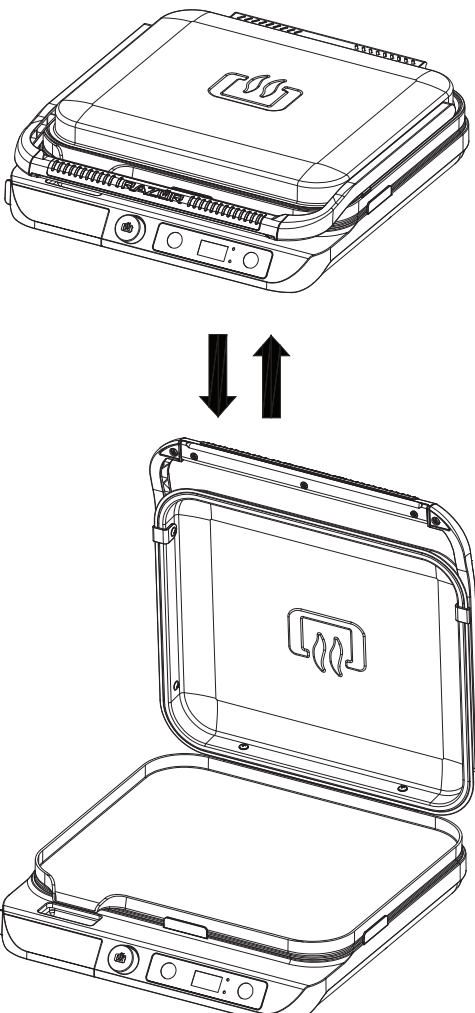

The diagram illustrates the second step of assembly. It shows the griddle with its lid open. Two black arrows, one pointing up and one pointing down, indicate the lid's movement. The lid has a handle on the right side. The griddle is shown in its open position, ready for use.

3

The lid is designed to be easily detachable and can be used as needed

Note: Make sure the lid is seated correctly.

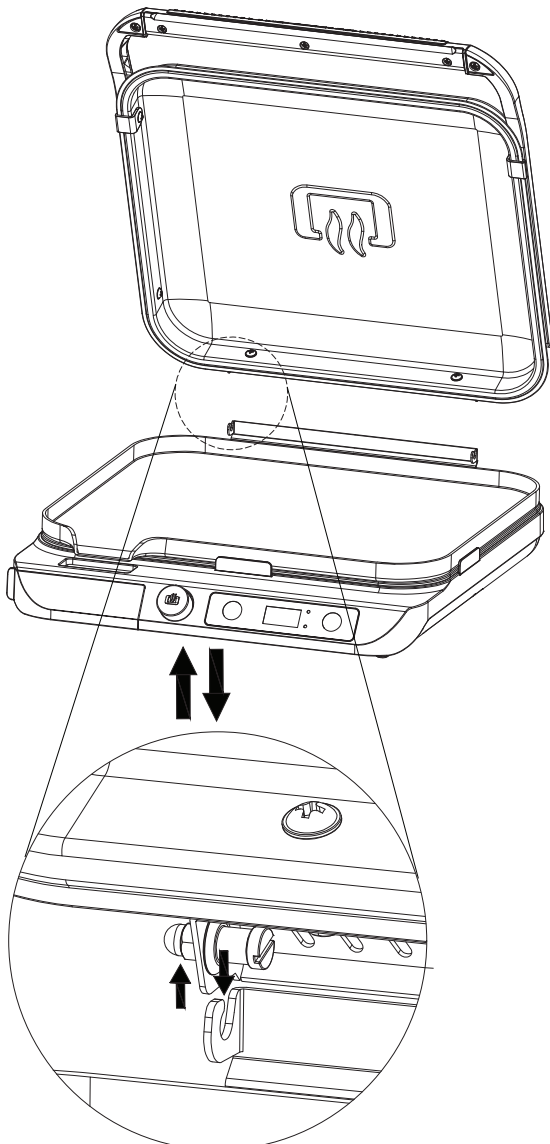

The diagram illustrates the third step of assembly. It shows the griddle with its lid open. A circular inset provides a close-up view of the lid's hinge mechanism. Two black arrows, one pointing up and one pointing down, indicate the lid's movement. The lid is shown being detached from the griddle.

4

Always empty and properly dispose of all items in grease cup



The diagram illustrates the fourth step of assembly. It shows the griddle with its lid open. A black arrow points to a small rectangular grease cup located at the bottom of the griddle. The grease cup is shown being removed from the griddle.

## CONTROL PANEL

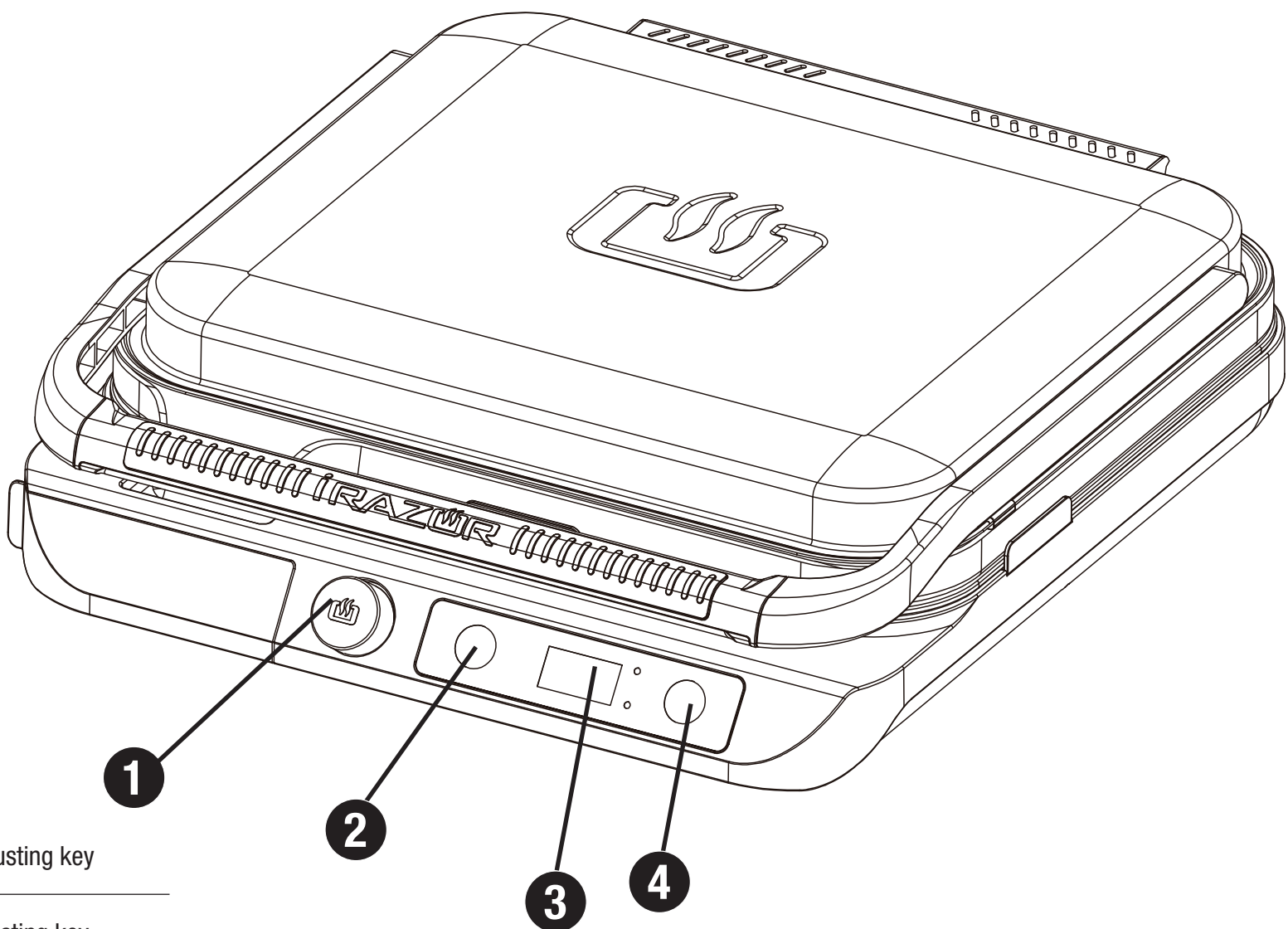

- |    |                     |
|----|---------------------|
| 1. | Power adjusting key |
| 2. | Timer adjusting key |
| 3. | Display screen      |
| 4. | Power On/Off Key    |

### Power Level

The induction cooker features 11 power levels, ranging from the lowest setting L0, P1, P2, P3, P4, P5, P6, P7, P8, P9, up to the maximum level H1. Consumers can easily select the desired power level by following “operating instructions”.  
Note: We recommend preheating your griddle on the induction for a few minutes before cooking.

## OPERATING INSTRUCTION

1. Power-up state: Press the on/off key to activate the induction cooking griddle. The screen will display “ON”.
  2. Power off: While in use, press the “Power On/Off” key, and the cooker will turn off. The fan will automatically run for heat dissipation.
  3. Standby state: Press the “Power On/Off” key to enter standby mode. If there is no action within 1 minute, the cooker will automatically shut down.
  4. Heating: In standby state, turn the knob left or right to select the power level. Wait for 2 seconds to start heating, and the power level will display on the screen.
  5. The “Timer” key functions with the “Power level” settings. The timer can be set after selecting the power level. Press the timer adjusting key once, and the LED screen will display “00”. Turn the knob left or right to decrease or increase the time setting, up to 1 hour or down to 0 minutes. The cooker will automatically confirm the time after 5 seconds. When the set time is reached, the cooker will turn off upon finishing the countdown.
- Note: When turn off the induction cooking griddle, the screen will blink “H” until the NTC sensor at the bottom of the panel cools down to 55°C.

**PROTECTION ERROR SIGN**

- 1. “E0”+ Buzzer sound: Internal working temperature too high, over heat protection system cut off the power, check the ventilation is enough and wait few minutes, it can start again.
- 2. “E1”+ Buzzer sound: If there is no cooking griddle on the cooking zone within 1 minute, the cooker will automatically shut down.
- 3. “E2”+ Buzzer sound: Lower voltage protection active, the local voltage is lower than 80V.
- 4. “E3”+ Buzzer sound: Higher voltage protection active, the local voltage is more than 145V .
- 5. “E7”+ Buzzer sound: Open circuit of NTC1 sensor, contact customer service 1-800-694-0013.
- 6. “E8”+ Buzzer sound: Short circuit of NTC1 sensor, contact customer service 1-800-694-0013.
- 7. “E9”+ Buzzer sound: Open circuit of NTC2 sensor, contact customer service 1-800-694-0013.
- 8. “EE”+ Buzzer sound: Short circuit of NTC2 sensor, contact customer service 1-800-694-0013.
- 9. “EF”+ Buzzer sound: Communication failure of induction, contact customer service 1-800-694-0013.

**CARE OF THE INDUCTION COOKING GRIDDLE**

Before being cleaned, the induction surface must be cooled down.

**Maintenance**

If you have a Razor, gas, griddle or other outdoor griddles, do not assume Cleaning and Maintenance will be the same. Because this is an electric griddle made of different materials and designed for indoor use, please follow the instructions included here.

**Daily Cleaning**

- 1. Be sure the grease cup is in place.
- 2. Wipe off the surface with a moist, soapy cloth or paper towel.
- 3. Wash off soap and dry.

**Deep Cleaning**

- 1. Be sure the grease cup is in place.
- 2. Turn heat to low.
- 3. While wearing rubber gloves, use one (1) tablespoon of dishwashing detergent per one (1) cup of hot water, and wipe down the griddle surface with a cloth or non-metal cleaning pad.
- 4. Turn off the griddle, and once cool, wipe off the surface with a moist, soapy cloth or paper towel.
- 5. Wash off soap and dry.

**Care**

- 1. Wash and dry by hand only.
- 2. Do not leave water on the griddle surface for more than two hours.
- 3. Avoid using anything that may scratch the surface, including metal scouring pads.
- 4. Do not cut directly on the griddle surface.
- 5. Do not allow the electric components to come in contact with water.

A good maintenance of the induction cooker requires a regular cleaning, care and servicing.

Warning: If power cord is damaged, please do not repair by yourself, to avoid a hazard, the manufacturer or approved technician is required to do the repair.

Please do not hit the induction surface, if crack appears in surface, switch off the power immediately to avoid the possibility of electric shock, contact customer service 1-800-694-0013 for help.

**Any other servicing should be performed by an authorized service representative.**

**WARRANTY**

We, undertake that if within warranty of 12 months from the date of purchase this appliance of any part thereof is proved to be defective by reason only of faulty workmanship or materials, we will, at out option repair or replace the same FREE OF CHARGE for labor, materials or carriage on condition that:

- The appliance has been correctly installed and used only on the electricity supply stated on the rating plate.
- The appliance has been used for normal, domestic purpose only, and in accordance with the manufacturer instructions.
- The appliance has not been serviced, maintained, repaired, taken apart of tampered with by any person not authorized by us.

All service work under this guarantee must be undertaken by an official authorized COOKING SURFACE Service Center. Any appliance or defective part replaced shall become the Company property. This warranty is addition to your statutory and other legal rights. This warranty does not include maintenance like cleaning of the induction cooker.

The manufacturer waives all liability for failure to observe the instructions for the appropriate installation, maintenance and use of the appliance.