

Check that you have all your parts and accessories.

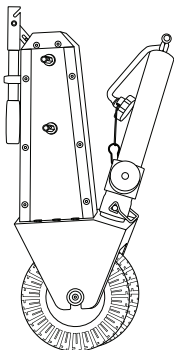

5X UNIT

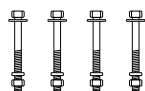

BRACKET BOLTS (4X)



SECURITY BOLT



STOW PIN



FOAM STRAP

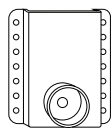

MOUNT BRACKET

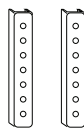

BRACKET CLAMPS (2X)

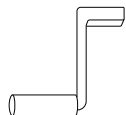

HAND CRANK



MANUAL



TRAILER VALET 5X

Quick Start Guide

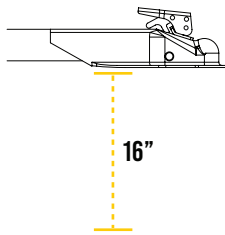

1. Check trailer height and raise the trailer tongue to where the frame is about 16 inches off the ground to give adequate space to attach the dolly.

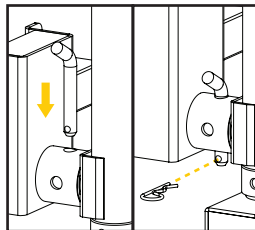

3. Secure utilizing the stow pin.

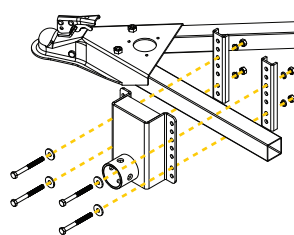

2. Install the 5X Mount Bracket to your the trailer frame.

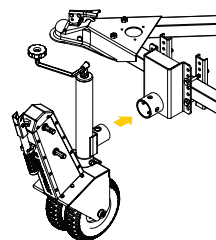

3. Connect the 5X unit to the Mount Bracket.

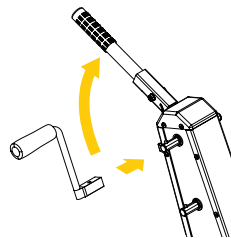

5. Attach the crank handle, lift the steering handle to disengage brakes, and start moving!

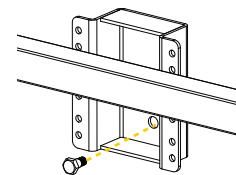

6. **OPTIONAL:** Lock with security bolt located in the back of the bracket to prevent removal.

IMPORTANT SAFETY INFORMATION

For information and assistance, please visit our support page at TrailerValet.com or give us a call at (844) 846-9344. Scan the QR code to the right for detailed safety and usage information.





MOVE *FORWARD.*